

Non-True 4K

True 4K

Clarity, uncompromised



XMP-7300

Ultra HD Web Appliance



Rugged Device

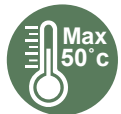

Wide Operation Temperature



Energy Saving



IP Streaming



Support Touch



Responsive Design

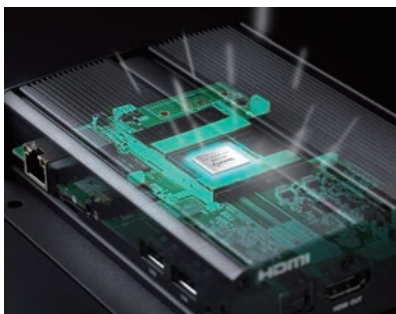

Quad-Core Graphic Engine

High performance meets high quality

Best performance with excellent energy saving – all packed in an unfailingly powerful quad-core graphic engine. No matter what project scale and complexity, your animations remain in the best condition around the clock.

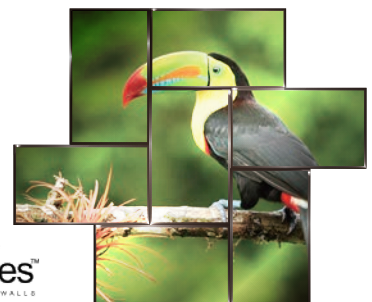

AnyTiles for professionals seeking the best video walls

IAdea's award-winning AnyTiles built in as part of XMP-7300, the pixel perfect and infinitely scalable technology is contoured for system integrators seeking the highest standard of video wall solutions.



True 4K anytime, any format, any angle

Your content will never be the same with IAdea True 4K technology. No limitation, no compromise on multiple zones and viewing modes. XMP-7300 brings you a whole new definition of 4K.



www.IAdea.com



Product Photos & Mounting Solutions

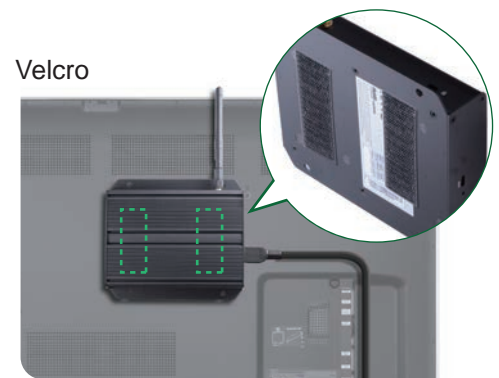
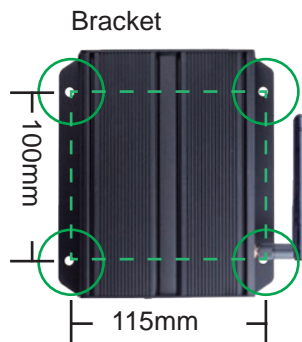

Technical Specification

Open Standards Supported

- HTML5, JavaScript, and CSS
- Android 4.4 API
- W3C SMIL for cross-platform management
- W3C Widgets for HTML delivery

Video Format Supported

- H.265/HEVC up to 4K (3840x2160)
- H.264/AVC up to 1080p (1920x1080)
- MPEG-4 up to 1080p (1920x1080)
- MPEG-2 up to 1080p (1920x1080)
- MPEG-1 up to 1080p (1920x1080)
- VC-1 up to 1080p (1920x1080)

Image Format Supported

- JPEG
- PNG

Audio Format Supported

- MPEG Audio (MP3)

Advanced Signage Features

- Remote commissioning
- AlwaysOn, AppLock to prevent unauthorized access
- StrongCache for continued playback even when network is not available

HTML5 Support

- Widgets for calendar, clock, news, weather, and web page integration
- HTML5 technologies including CSS and Javascript
- WebKit-based browser engine, same as Google Chrome™ and Apple Safari® browsers

Digital Signage Features

- Multi-zone screen layout, transparent PNG overlay, and graphical scrolling ticker
- Auto-play starts playing scheduled contents automatically when power is re-established
- Automatic error recovery with built-in WDT
- Real-time clock with backup clock battery

Content Management

- SignApps Express Utility
- 3rd party solution (optional license)

Connectivity

- Gigabit Ethernet
- Wireless: 802.11 b/g/n (2.4 GHz)
- HDMI 2.0 (3840x2160 @60fps)
- Micro USB for ADB
- USB 2.0 x 2
- 3.5mm analog stereo audio out
- S/PDIF out
- AniBeacon™ (BLE)
- Optional 3G/4G mobile module via USB

Local Storage

- 8GB/16GB eMMC built-in
- Micro SD card slot (card replaces internal storage)

Mounting Kit

- Built-in wall mount bracket

Supplied Accessories

- HDMI cable
- External 2dB Wireless antenna
- Velcro
- Power /Micro SD card brackets

Expansion Options

- 16GB/32GB micro SD/SDHC memory card

AC Adapter

- Input: 100-240V, 50-60 Hz, 0.5A Max.
- Output: 12V, 1.5A
- UL/CB/PSE certified power supplies
- Interchangeable connector system includes US plugs (Option for EU, UK and AUS plugs)

Environmental

- Operating temperature: -20 to 50°C
- Humidity: 10 to 85% @ 45°C, non-condensing
- Shock: IEC 60068-2-27 Table A.1 (railway related)
- Vibration: 1.5G @ 5-200Hz, random

Dimensions for Product & Package

- Size: 143.60mm(W)x 128.13mm(H)x 33.65mm(D)
5.65"(W) x 5.04"(H) x 1.32"(D)
- Weight: 478 g / 1.05 lbs.
- Individual Package Size: 226mm(W) x 172mm(H) x 89mm(D)
8.89"(W) x 6.77"(H) x 3.5"(D)
- Outer Carton Size: 482mm(W) x 390mm(H) x 245mm(D)
18.87"(W) x 15.35"(H) x 9.64"(D)
- Units per Outer Carton: 10

Certifications

- CE/FCC/IC

Warranty

- 1-year limited parts & labor

Contact



QUANTUM SPHERE
GATEWAY TO EXCELLENCE

\$, #, ° & « " µ # 1/2 \$

" ° 2 »

, , µ " ! & " , µ " - µ

#

~ ¶ µ " ¶ ¶ « " µ ¶ 2° µ

1

o o o " ¶ « " µ ¶ 2° µ

Idea America Corp.

20 Fairbanks, Suite 170

Irvine, CA 92618

Tel: +1-949-305-6489

Email: US-Sales@Idea.com

